

FED. ROAD DIST. NO.	STATE	JOB PIECE NO.	FISCAL YEAR	SHEET NO.	TOTAL SHEETS
6	OKLA.				
DESCRIPTION		REVISIONS		DATE	

PHASE 2 (MAINLINE)

STA. 106+00.00 TO STA. 284+06.04
 UNCL. EXCAV. = 78,796 C.Y.
 EMB. + 15% = 75,513 C.Y.
 EXCESS EXCAV. = 6,283 C.Y.

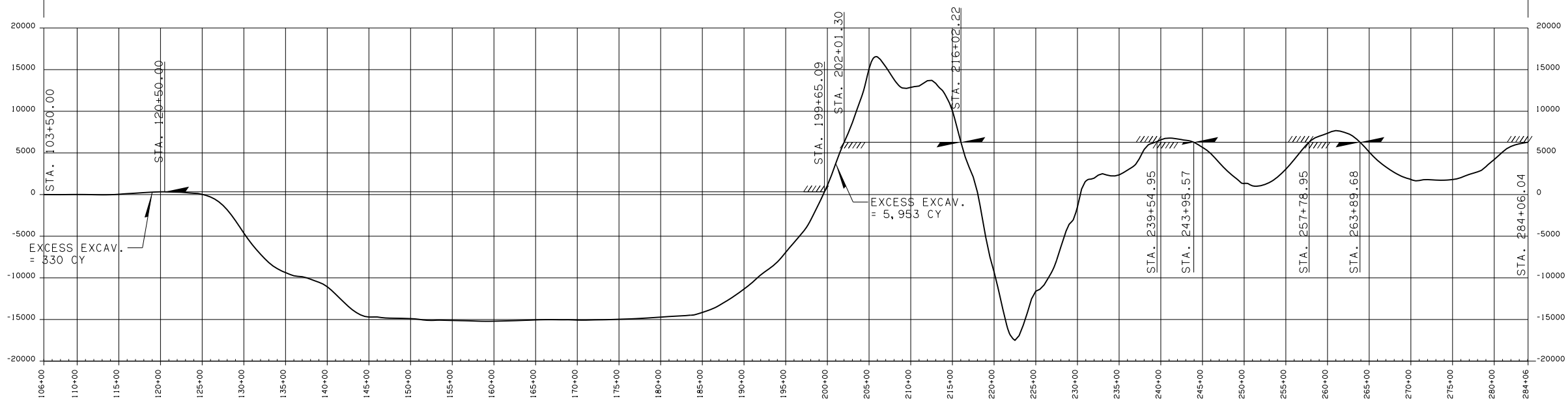

PHASE 3 (MAINLINE)

STA. 206+00.00 TO STA. 235+00.00
 UNCL. EXCAV. = 14,524 C.Y.
 EMB. + 15% = 5,512 C.Y.
 EXCESS EXCAV. = 9,012 C.Y.

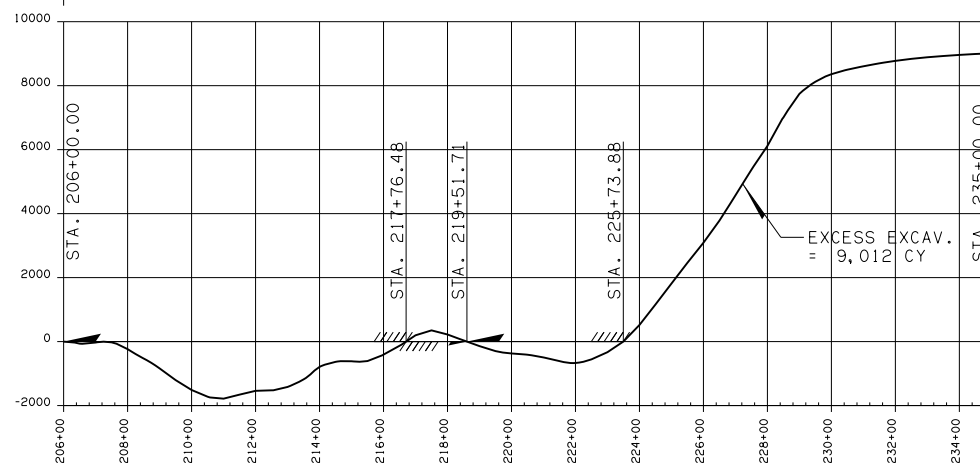

MASS DIAGRAM PROVIDED FOR BIDDING PURPOSES ONLY. ACTUAL BALANCE POINTS TO BE DETERMINED BY CONTRACTOR AND VOLUME OF MATERIAL ENCOUNTERED DURING GRADING OPERATIONS. WHENEVER POSSIBLE, THE CONTRACTOR SHALL SEQUENCE EARTHWORK OPERATIONS IN ORDER TO OBTAIN THE MATERIAL FROM THE CUT SECTION FOR USE AS FILL RATHER THAN OBTAINING UNCLASSIFIED BORROW. MATERIAL DEPICTED AS WASTE SHALL ONLY BE CONSIDERED WASTE ONCE ALL EARTHWORK OPERATIONS HAVE BEEN COMPLETED. THIS MATERIAL SHALL BE USED TO REDUCE THE NEED FOR UNCLASSIFIED BORROW AT ANY LOCATION AND TIME THROUGH THE DURATION OF THE PROJECT.

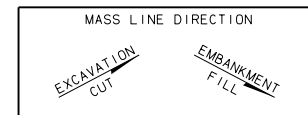

DESIGN	GC	
DRAWN	RM	
CHECKED	CC	
APPROVED	CS	
SQUAD	DEWBERRY	

MASS DIAGRAMS